

Beltrami County Natural Resource Management Timber Appraisal Report

Project Plan #	FH-19-782	TSM Permit #	219044	Bid Type:	Oral	Access:
Township	Nebish	Ownership:	Tax forfeit	Public		
Expiration Date	5/8/2022	Sale Duration:	33 months	Season:		
Forester	Garret DeChaine	Appraisal Date	6/28/2019	Frozen		

Quarter	SE - Select	Section	9	Township	149	Range	33	Location:
Quarter	SE - NE	Section	9	Township	149	Range	33	Lat. (NDD.dddd°)
Quarter	NW -	Section	16	Township	149	Range	33	N 47.73
Quarter	-	Section		Township		Range		Long. (WDD.dddd°)
Reserve Trees	Cedar, oak, elm							W 94.878
Sale boundaries	Blue Paint							

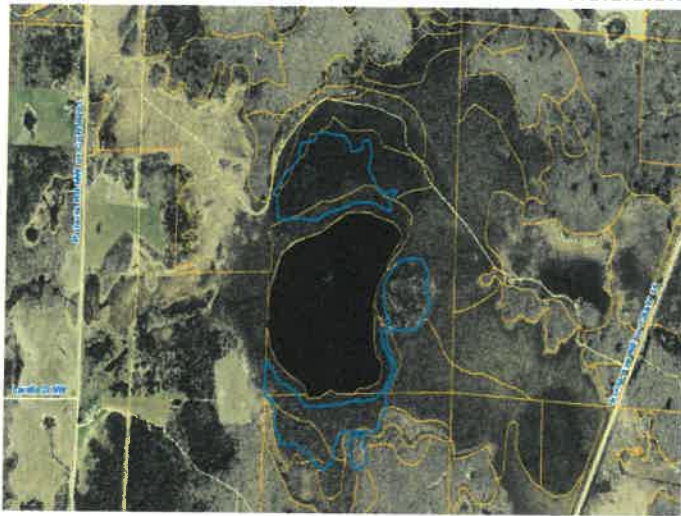

Cover Type	Harvest Acres	Treatment Method
71-Black Spruce	23	Full Harvest
72-Tamarack	18	Full Harvest
20-N Hdwds	9	Full Harvest
12-Aspen	1.5	Full Harvest
Visual Sensitivity	Low	
Management Actions to Address Visual Sensitivity		
Select		

Timber Appraisal

Code	Species	Product/Unit	Volume	Price/Unit
	Tamarack	Pulp/Cords	375	\$3.00
	Black spruce	Pulp/Cords	170	\$8.00
#	Basswood	Pulp/Cords	130	\$7.00
	Aspen	Pulp/Cords	80	\$18.00
#	Balsam fir	Pulp/Cords	75	\$7.00
#	Birch	Pulp/Cords	75	\$7.00
#	Ash	Pulp/Cords	30	\$7.00
Total price (calculated in TSM)				\$ 6,095
<i>Codes: + Area estimate, # Non-bid, * Non-bid area estimate, blank scaled</i>				

Land Commissioner Review

<i>Ram 6/27/2019</i>	
GIS Inventory Updated	
PP&I Updated	
Purchase Information:	
Bid %	
Bid up total	
Balance Due	\$

Additional Comments: Main block of sale is 3 ½ miles north of County Rd 26 on County Rd 201. Northern block is best accessed off County Rd 201 and east ¼ mile on snowmobile trail; southern block is best accessed through private to west, or, off County Rd 15 and west ½ mile on snowmobile trail with additional ½ mile of new woods road into sale block. Tamarack listed in the appraisal is combination of live, dead, and infested. As 2/2019 majority of tamarack was live. Due to presence of mistletoe in the northern black spruce block operator will be required to kill all black spruce stems 5' and above. See PPI for RMZ around Anderson Lake.

Project Planning and Instructions to Contractor(s)

Project ID FH-19-782

Anderson Lake

Primary Contractor:

Secondary Contractor:

Forester: Garret DeChaine

PROJECT

Overall Site Objectives:..... Long-term maintenance of multiple covertypes.

Management Objectives:.....

Stand	Objectives	Acres
All	Clearcut harvest all listed species on timber appraisal and aerial seed tamarack and black spruce; allow for natural regeneration of other listed species on upland site.	51.5

Timing:..... Frozen ground only

Legal Description:.....

Stand ID	Township	Range	Section	Quarter
6 T43, 5 T41	149	33	16	NW
60 BSL42, 66 BSL16, 62 NHS7, 65 T41, 67 T41	149	33	9	SE, SENE

Timing Additional Instructions:.....

Equipment Considerations:.....

Site Access:..... Public

Site Access Addit'nl Instructions: Private access to the timber south of Anderson lake would be best option.

Site Geography:.....

Sandy Loamy Clay Organic Rock Outcrop Stony

Dominant Terrain:..... Level

Soils Terrain Add'nl Instructions: NPC Class: FP and MHN44

HARVEST SPECIFICATIONS

Number of Landings:..... 3

Average Size of Landings:..... 15000

Landing Location:..... Upland

Landings Addit'nl Instructions:.....

Skid Trail Parameters:.....

Parameter List

Keep Primary and Secondary Skid Trails <10-15% of Timber Harvest.
 Locate skid trails within sale area.
 Use Primary and Secondary Skid Trails.

Skid Trail Add'ni Instructions:.....

Average Stump Height Must be Less Than 12 Inches!
All Non Reserved Merchantable Wood Must be Utilized!

Utilization Add'nl Instructions:.....

Slash Must be Scattered over the Harvest Area!

Slash Additional Instructions:.....

ROADS AND WATER CROSSINGS

General Comments:..... Operator will need approximately 1/2 mile TFAT into sale.

Post Activity Road Work:.....

Responsibility:.....

Road Status Add'nl Instructions:.....

RMZs AND FILTER STRIPS

RMZ General Comments:..... Operator will satisfy RMZ requirement by staying within sale boundary



Project Planning and Instructions to Contractor(s)

Project ID FH-19-782

Anderson Lake

Primary Contractor:

Secondary Contractor:

Forester: Garret DeChaine

Non-Trout Lakes, Streams and Open Water Wetlands:.....	Location	Management	Strip
	N,S,E sides of Anderson Lake	All Non-trout streams >= 3' wide, lakes, and open water wetlands >= 1 ac. in size - 120' - Basal area = 60 sqft min - 5% patch in adjacent areas.	50ft

Wildlife Considerations

T + E Species Present:	None noted
Other Wildlife Species of Concern:	None Present.
Protective Measures:	Protective Measures Not Applicable. Database Checked No new identified species on site.
Other Wildlife Elements:	Physical spacing of activities, where spacing is beneficial to wildlife. Timing of activity, where timing is beneficial to wildlife. Timber reserves within or adjacent to the project area not less than 5% of the area. Food sources reserved.
Leave Tree Snags:	Leave All Snags EXCEPT Safety Hazards! Leave All Snags Except Visual Not Applicable. Leave All Snags EXCEPT those with Insects or Disease Not Applicable.
Leave Tree Instructions:	No Leave Tree Instructions. Coarse Woody Debris Per Acre Not Applicable. Scattered Leave Trees Not Applicable. Understory Conifer Retention Not Applicable. Maintain Oak and Other Mast (Cherry, Mountain Ash, Elderberry, etc.)! No Den Trees To Reserve.
General - Leave Trees/Snags:	No General Snags and Leave Trees Comments.

VISUAL SENSITIVITY

Database Checked:	Yes
Visual Sensitivity of Site:	Low

CULTURAL SITES

Database Checked:	Yes
Conservation Plan:	No conservation management plan in place at this time.
Feature Present:	
New Identified on Site & Mapped:..	No



Polaris Rd NW or CoRd 201

Irvine Ave NE or CSAH 15

