



# BELTRAMI county *est. 1866*

PRST STD  
U.S. POSTAGE PAID  
BEMIDJI, MN  
PERMIT NO. 40  
Residential Customer  
ECRWSS EDDM

*Minnesota*

## *News and Highlights*

1st Quarter 2022

[www.co.beltrami.mn.us](http://www.co.beltrami.mn.us)

**Beltrami County Mission and Values:** We will strive to be the catalyst to firmly establish a community that promotes healthy families, environmental quality, expanding economic opportunity and a quality of life second to none.

### Beltrami County Jail Project Update

The Beltrami County Jail Project has reached a new milestone when Justice Planners, LLC was awarded the contract to complete a Jail & Justice Study and Feasibility Assessment.

In Board action taken February 1, 2022, the County Board voted to award the contract to Justice Planners, LLC as recommended by the Jail Project Steering Committee.

On November 18, 2020, the Jail Project Steering Committee published a Request for Proposals (RFP) to conduct the study. Two firms responded to the RFP; Justice Planners, LLC, and Mark Goldman and Associates.

After careful review, the Jail Project Steering Committee unanimously voted to enter into contract negotiations with Justice Planners, LLC. The contract allows up to \$130,500 to be spent fulfilling the contract requirements.

The purpose of the Jail & Justice Study and Feasibility Assessment will be to guide the Beltrami County Board of Commissioners and our citizens on what improvements are needed to provide maximum efficiency and effectiveness of the criminal justice system and help create a sensible guide for any future planning. This will be done through the analysis of data and interviews with key community stakeholders to create statistical models to predict our future needs.

The process will begin with the collection of years of statistical data as well as interviewing key stakeholders in the process. Key Stakeholders will include Sheriff's Office staff, County Commissioners, area law enforcement agencies, the judiciary

and court administration, the Beltrami County Attorney's Office and City of Bemidji Attorney's Office, Minnesota Public Defenders Office and the local Bar Association, as well as representatives from our area Health and Human Service agencies.

The data analysis will provide a 'start to finish' assessment of all workflows and processes of the criminal justice system with special attention being paid to:

- Alterations to improve efficiency and effectiveness
- Alternatives to incarceration
- Impact of information technology on the criminal justice system
- Potential impacts to the criminal justice system by changes to State and Federal laws as well as public policy
- Mental Health Issues
- Demographic disparities

The final report will cover statistical forecasts for jail population for next 10, 25 and 40 year periods. It will also provide an analysis of all the key scenarios that the Jail Steering Committee agreed upon including possible renovation of our current facility, possible expansion of our current facility, potential construction of a new jail facility (tear down and rebuild or new adjacent facility) or identification of a more advantageous alternative that has not already been identified.

The study is scheduled to be completed by mid-August, 2022.

*Submitted by: Sheriff Ernie Beitel*

**STAY UP TO DATE ON THE WEB**

A new web page dedicated to information on the Jail Project has been developed to keep the public up-to-date on the latest project developments. On the web page you will find reports, studies, news articles, meeting minutes and other helpful information.

Visit the Beltrami County Website at:  
[www.co.beltrami.mn.us](http://www.co.beltrami.mn.us) and click on the Law Enforcement link on the left, and then the Jail Project Link on the left, for information and updates on all the Jail Project Committee Information.

Inside	<i>Some of the information you will find inside includes:</i>			
	2022 Redistricting	2	Sheriff's Office 911 Call Center	5
	Public Assistance Update	2	Bemidji Regional Airport	6
	Facilities Management & Safety	3	Shooting Sports Park	6
	Property Assessments	4	Remonumentation	7
	Short Term Rental Ordinance	5	Keep it Clean Campaign	8

# 2022 Redistricting

Redistricting is the process of redrawing the boundaries of election districts to ensure that residents of each district are equally represented. It is typically done nationwide every 10 years after the completion of the decennial Census.

Minnesota Statutes identify which districts need to be redistricted and the process by which that happens. Starting with both chambers of the State Legislature, district boundaries are drawn so that approximately the same number of persons are in each district. The State has gone through the Judicial process with the following local area maps being released:

## Minnesota House Districts

## Minnesota Senate Districts

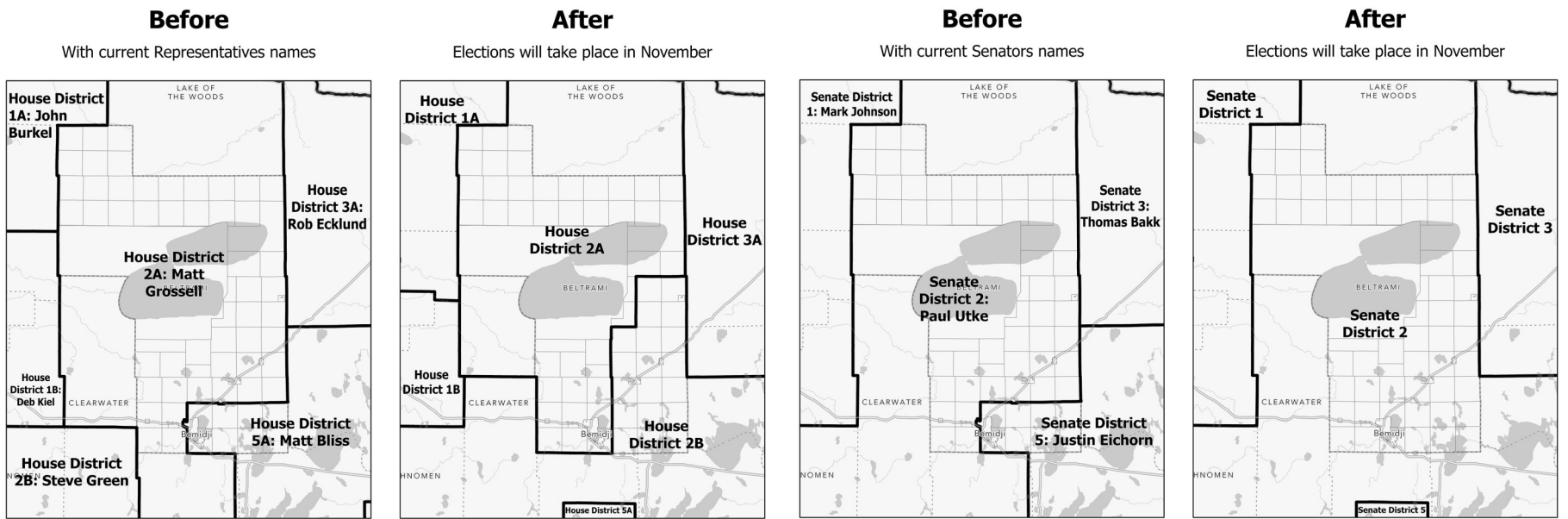

The process has now moved on to municipalities. The deadline for cities to complete their redistricting is March 29, 2022. Again, the goal is to have equal representation among all residents.

Once Municipal redistricting is complete, the process moves on to the remaining districts, including the county, schools and SWCDs. Redistricting of Schools and SWCDs is not necessary if voters vote for candidates in all districts, as is the case within Beltrami County. There will be Board discussion and Public Input during the month of April with the deadline for final boundaries being April 26, 2022.

Beltrami County has started reviewing maps and population data within the Redistricting Committee made up of the Administrator, Auditor-Treasurer, and GIS Director. We will be updating the County Board and County Residents as milestones are reached along the way. When the redistricting process is complete, voters will receive a redistricting notice post card indicating the election districts they now reside in and the location of the polling place. These post cards will be mailed in early summer.

~Submitted by: Auditor/Treasurer, JoDee Treat and GIS Director, Kevin Trappe

## Public Assistance Office Update

**Have you applied for a public benefit program such as cash assistance, SNAP or Emergency Assistance?**

**Did you provide a phone number?**

For many public benefit programs, you must complete an interview before benefits can be issued.

All interviews are now completed by phone. If you do not have access to a phone, come in to the office and inquire at the front desk on the Second Floor of the Community Service Center, 616 America Ave. NW, Bemidji.

Your name, address and a phone number will be required to complete the interview.

Staff will be calling you from phone number 218-333-4299. Please add this number to your contacts so that our call will not be blocked. This number does not accept calls.

Office hours are Monday through Friday 8:00 a.m. to 4:00 p.m.

Phone hours are Monday through Friday 8:00 – 4:30 p.m. at 218-333-8300.

Drop off documents at any of our drop boxes, fax is available at 218-333-4150 or you may upload your documents at <https://www.co.beltrami.mn.us/Departments/HHS/HHS%20Home.html>.

There may be delays in processing due to large application volumes at this time. Beltrami County staff is working very hard to meet your needs.



**Beltrami County Health and Human Services**  
**Income Maintenance Department**  
 616 America Ave Suite 270  
 Bemidji, MN 56601  
 Phone: 218-333-8300 Fax: 218-333-4150

# Clip and Mail

Your opinion and feedback is important to us... tell us how you feel and return this clip to:

Beltrami County Administration

701 Minnesota Ave NW

Bemidji, MN 56601

OR e-mail to: [webmaster@co.beltrami.mn.us](mailto:webmaster@co.beltrami.mn.us)

1. Did you find the information in this Newsletter helpful?

2. What would you like to see in future issues of the Beltrami County News and Highlights?

3. A question I have of the County Board is:

4. A suggestion I have for the County Board is:

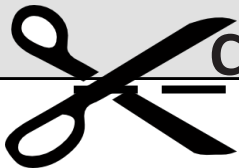

**Clip and Send**



**2022**

The Beltrami Soil & Water Conservation District is currently holding its annual tree sale. The SWCD offers 30 species of low-cost, bare root trees to area residents. There are also seed mixes and plant plug kits specifically designed for pollinator, lakeshore, and woodland settings. Trees, plants, and seeds can be ordered now and picked up in late April. Stock is running low on a number of species, so be sure to place your order soon! Tree order forms are available in the SWCD office and online at the Beltrami County website. For more information or to check availability please call 218-333-4158.



## Facilities Management and Safety Department

The Facilities Management and Safety Department consists of seventeen employees with a common mission to provide a safe, clean, comfortable and efficient environment for all county customers/citizens, tenants, and staff that occupy county buildings. Our department is considered a service department; we manage and maintain buildings and grounds and provide services to others. Building management, project management, energy management, building and grounds maintenance, custodial, and safety are some of the services we provide to tenants and county departments.

We manage approximately 325,000 square feet of building space in addition to outdoor grounds space. Of this space, we lease approximately 40,000 square feet which generates revenues of just over \$596,000 annually which helps to offset the nearly \$2 million department budget.

As I mentioned above, the Facilities Management and Safety Department is comprised of seventeen employees, a facilities manager, four maintenance mechanics and twelve custodial staff consisting of full-time, part-time, and casual status. These individuals maintain our buildings and grounds providing high levels of cleanliness and maintenance to our facilities. This department is unique because we also conduct approximately 95% of all HVAC (heating, ventilating, air conditioning) work in-house, which allows for extremely thorough preventive maintenance to be conducted, faster response times for any needed repairs, and significant savings to the county.

Beltrami County has a long history of energy management within county buildings. Some energy audits and commissioning efforts go back into the 70's and 80's however some of the more recent energy audits have taken place in 2009 and again in 2012 and most recently in 2020. Having energy efficient facilities ensures that we minimize the amount of tax dollars required to operate county buildings. The 2020 audit and recommissioning project was conducted by Michaels Energy and was fully funded by our utility providers Ottertail Power Company and MN Energy Re-

sources. The project showed that our facilities were already operating at significantly higher efficiencies than other facilities of similar characteristics and size thus saving the county an average of \$86,000 annually. The results of the audit also identified ways we could reduce our energy consumption even further by upgrading our lighting systems which is a project that is expected to be completed this year with Beltrami County receiving an estimated \$57,000 rebate from Ottertail Power Company and an annual electrical savings of \$29,000.

Last year Beltrami County received electrical rebates totaling \$7,659 for qualified energy projects that were completed. In the past, Beltrami County has received many rebates for upgrading boilers, motors, chillers, lighting systems, and implementing other energy reducing projects. Reducing our energy consumption is good for the county and for our utility providers.

In December of last year, Beltrami County was presented a Certificate of Excellence for "Outstanding Experience in Workers' Compensation" for the years 2018-2020. This was recognition for Beltrami County's efforts to provide a safe working environment for all employees through the development, implementation, and enforcement of safety policies and procedures. The Facilities Management and Safety Department works with county administration, our risk manager, and all county departments to minimize safety risks and hazards for county employees. Beltrami County held this excellence rating for a number of years and received significant savings in insurance premiums due to this rating. In 2021 the county experienced some employee accidents and injuries that were difficult to control or plan for which resulted in some additional worker compensation claims that removed us from our outstanding status which resulted in a premium increase. Our goal is to always be looking at ways to minimize risk, reduce or eliminate accidents and injuries and to obtain a high insurance rating which will reduce premium costs for the County and provide a safer working environment for county employees.

*~Submitted by: Facilities Manager/Safety Coordinator, Steve Shadrick*

# Property Assessments in an Appreciating Market

## Can Result in Large Changes

### Valuation Date

The soon to be mailed **2022** Valuation Notice includes an estimated property value as of January 2, 2022. That value is utilized in the calculation for taxes payable in **2023**.

### Sales Study Period

For the January 2, 2022 assessment the assessor considers sales that occurred between October of 2020 and September of 2021.

### Not All Sales Included

Not all sales are representative of the market. Some sales, such as foreclosures, sales between relatives, or sales where the seller or buyer are acting under undue duress are not considered open-market, arm's-length transactions. These sales are not used in sales ratio studies, nor are they used as comparable sales in estimating the value of similar properties.

### Appreciating Market

Over this past year the real estate market in Beltrami County has seen significant gains, greater than experienced in recent history.

Sales occurring prior to the assessment date must be analysed with consideration due to appreciation that may have occurred between the sale date and the assessment date.

### Mass Appraisal Is Not Based on an Individual Sale

It's also true that people purchase property based, at least in part, on their own preferences. This results in perceived "good" and "bad" deals occurring every day. Mass appraisal techniques seek to value all properties based on the sale transactions of many similar properties.

The assessed value is not based on an individual sale, but rather a consideration of many sales, resulting in an indicated value, or a price it would "most likely" sell for.

**"Wait a second, I paid \$300,000 for my home and now you're saying it's worth \$360,000. How is that possible?"**

The assessment date is January 2 of each year. If the market appreciated, for example 20% in your area, then:

A purchase price of **\$300,000** in January of 2021 would indicate a value closer to **\$360,000** as of January of 2022.

A purchase price of **\$330,000** in July of 2021 would also indicate a value closer to **\$360,000** as of January of 2022.

**We are currently seeing +20% annual appreciation**

*~Submitted by: County Assessor, Joe Skerik*



**We are seeing the largest market adjustments in decades**

**Consider a market where property values appreciated 20% over the past year**

## New Plat Books Available Now

Plat books are available for \$40 at the following locations in the County Administration Building:

- GIS Department
- Real Estate and Tax Services
- Environmental Services

You can also order a plat book in the mail (additional postage applied). Visit the county website at:

<https://www.co.beltrami.mn.us/Departments/GIS/Maps.html>

Or scan the QR Code:

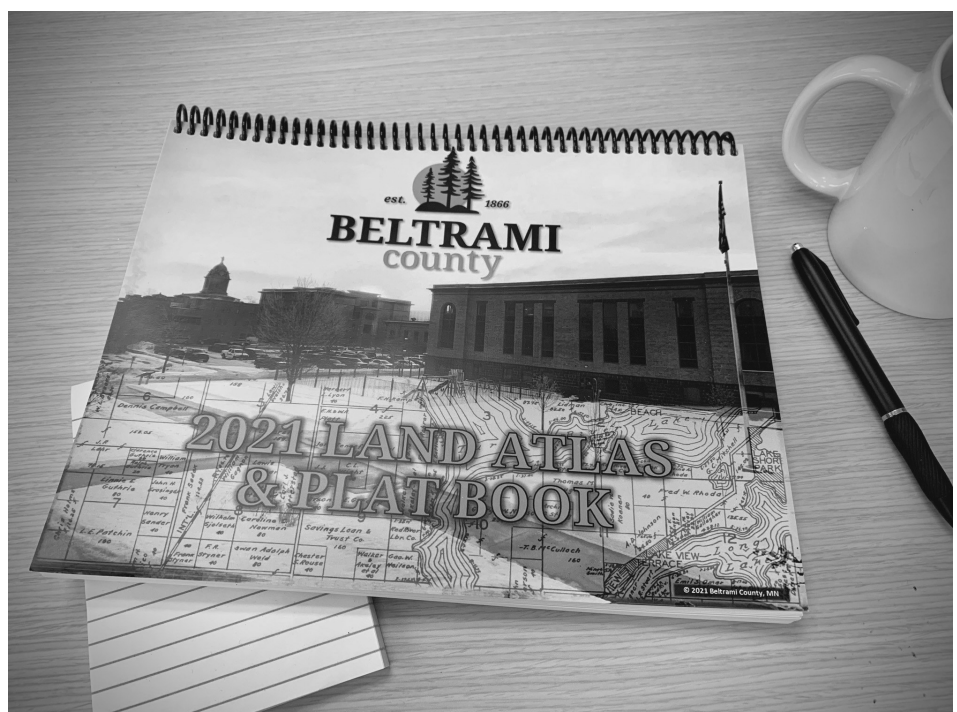
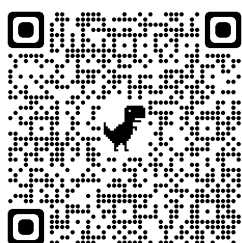

# Short Term Rental Ordinance

The Beltrami County Board of Commissioners set a Public Hearing date of March 15<sup>th</sup>, 2022 at 5:00 PM in the County Board Room for the purpose of gathering public comments related to the draft Short-Term Rental Ordinance.

The County Board received several complaints regarding short-term rental units operating in Beltrami County in 2021. The County Board requested that the Planning Commission and Environmental Services Department prepare a draft Ordinance to regulate short-term rental units in Beltrami County. After several work sessions discussing the pros and cons of all possible options regarding regulating short-term rentals in Beltrami County and a public hearing at the Planning Commission level, a draft Short-Term Rental Ordinance was completed and forwarded to the County Board for public hearing and consideration for approval.

The highlights of the draft Short-Term Rental Ordinance include:

- A permitting requirement for all short-term rentals
- Local manager able to respond to complaints and problems is required
- Septic system compliance required and system sizing will dictate occupancy limits
- No special events (ie. Weddings) allowed at short-term rentals
- 1 short term rental allowed per parcel in the shoreland zone, if more than 1 permit as a resort
- Off street parking required

- Quiet hours from 10PM – 8AM to preserve peaceful residential neighborhoods
- Complaint process – repeat problem rental units may lose their license to operate

To access the full draft Short Term Rental Ordinance please go to the Beltrami County website ([www.co.beltrami.mn.us](http://www.co.beltrami.mn.us)) and you will find the draft ordinance along with details of the public hearing on the home page.

If you have any questions about the Short-Term Rental Ordinance, the process for adopting and enacting an Ordinance, or other concerns regarding this topic, please feel free to contact Brent Rud at the Environmental Services Department at 218-333-4158.

*~Submitted by: Environmental Services Director, Brent Rud*

**A PUBLIC HEARING WILL BE HELD:**  
**701 Minnesota Ave NW, Bemidji, MN**  
**County Board Room**  
**March 15, 2022**  
**5:00 pm**

## ***Sheriff's Office 911 PSAT Call Center Changes to Automated Answering Attendant***

Historically, the PSAP center has been the answering point for all calls for the Sheriff's Office and Police Department, whether they were emergencies, non-emergencies or business type calls. In the past, by calling one number, the public could reach a 911 Dispatcher who would figure out where to route your call.

Today, because of the high number of 911 emergencies calls the PSAP handles every hour, we are finding it extremely difficult to provide the personal customer service for non-emergency and business calls that come into the 911 call center. Our 911 calls take priority over all other calls so in order to continue to service our non-emergency and business calls we have implemented an automated answering attendant.

In an effort to reduce the high number of non-emergency, business type calls for the Beltrami County Sheriff's Office and the Bemidji Police Department, the Beltrami County 911 PSAP center has implemented more options to the automated answering attendant.

This is ONLY for the non-emergency, business calls and DOES effect the answering of 911 emergency calls.

When dialing 218-333-9111 you will get the following options:

**"You have reached the Beltrami County Law Enforcement Center, please listen to the menu as options have changed. If this is an emergency, hang up and dial 911."**

**"For dispatch, including to speak to an officer, request an ambulance or report a crime, press 2."**

**"For records, including copies of police reports, gun permits and vehicle releases, press 3."**

**"For court security, including fingerprinting and inmate transport, press 4."**

**"For the Beltrami County jail, press 5."**

**"For the Bemidji Police Department administration, press 6."**

**"For the Sheriff's Office administration, press 7"**

**"For civil process, including paper service, press 8."**

**"For courts, including applying for an OFP and HRO, paying a citation or inquiring about a court date press 9."**

**For First Call community resources, hang up and dial 211.**

**If these options do not meet your need, press 2.**



## The Bemidji Regional Airport

To say that the aviation industry has experienced turbulence over the last two years would be an understatement. The industry was sent into a tail spin and bottomed out in April 2020 when BJI had just 124 departing passengers when the monthly average is usually about 2,300 to 2,500 departing passengers. About the same time passenger traffic across the country dropped by about 95%. Nationwide traffic has rebounded to about 80-83% of pre-pandemic levels and locally to about 85-87% of pre-pandemic levels. Total passenger count for 2019 was 61,862 (new record); 2020 was 33,297 and 2021 was 51,514. BJI is served by SkyWest Airlines flying under Delta Air Lines' brand. Through the Department of Transportation's Essential Air Service (EAS) program, SkyWest provides BJI with 14 round trips to the Minneapolis/St. Paul International Airport (MSP). BJI is fortunate as most communities in the EAS program only have 12 roundtrips per week. BJI's EAS per passenger subsidy has historically been about \$26, making it the 5th lowest subsidy in the nationwide EAS program. Effective March 1st the DOT reselected SkyWest to provide EAS at BJI through February 28, 2025.

In addition to commercial air service, BJI has robust general and corporate aviation air traffic activity. This ranges from air cargo; students learning to fly; an air ambulance transporting a patient; bringing specialty doctors to see patients at local clinics; aircraft restoration; pipeline patrol; corporate management visiting their stores in the area; and local business people traveling to their other work sites.

The Bemidji Regional Airport Authority was created in 2010 by a joint resolution between the City of Bemidji and Beltrami County. The Authority Board consists of Chairman John Knorr (lay member appointed by the City and County); Ron Johnson and Jorge Prince from Bemidji City Council; and Jim Lucachick and Reed Olson from Beltrami County Board. The Board holds public meetings on the third Wednesday of each month at 5:00 p.m. in the Authority's conference room. Agendas and additional information may be found at [www.bemidjiairport.org](http://www.bemidjiairport.org). The Authority is funded by user fees; lease payments; local levy; passenger facility fees (PFCs); federal and state grants.

BJI is open 24/7 so the Authority staff must do a wide variety of duties and tasks, such as, Aircraft Rescue and Firefighting (ARFF); snow and ice control on runways, taxiways, ramp, roadways, sidewalks and parking lots; aircraft deicing; airfield, equipment and building maintenance; construction coordination; emergency planning; administration and financial tasks; Federal and State grant management; lease negotiations and janitorial services. The Authority's staff of full-time and part-time employees is very dedicated and takes a lot of pride in keeping BJI safe, efficient and clean. Current staff includes: Karen Weller, Kyle Christiansen, Will Luggar, Kelly Skime, Terry Munter, Dick Sathers, Gary Gregg, Dean Kvalevog, Lee Kalkbrenner, Scott Hinners, Jeff Skime, Angela Demaris and Holly Ritter.

In an effort to not to get behind the power curve, over the last few years BJI has embarked on and completed several improvements, such as, a major terminal expansion including a passenger boarding bridge; a new building for Authority equipment and employees; ten T-Hangars; four Corporate Hangars; a new taxiway; new aircraft parking ramps; various projects to preserve or replace most of its airfield pavement; obtain new equipment for snow and ice control; and new privately-owned hangars. We are currently in the design phase for a major runway pavement preservation project as well as some new snow removal equipment and obstruction control. If you haven't been to the airport in a while, we invite you out to take a look around.

The Authority acknowledges and appreciates our partners that help keep 'em flying at BJI – City of Bemidji; Beltrami County; Law Enforcement from the City and County; Bemidji Fire Department; Karvakko; Bemidji Aviation Services Inc.; Delta Air Lines; SkyWest Airlines; Sun Country Airlines; Corporate Air; UniFi; Transportation Security Administration (TSA); Federal Aviation Administration (FAA); Minnesota Department Transportation Office of Aeronautics; Bureau of Indian Affairs (BIA); Minnesota Department of Natural Resources (DNR); AirCorps Aviation; Barnstormers; Enterprise.

~Submitted by: Executive Director, Karen Weller

Commissioners can be contacted by phone or e-mail:

**District 1 Commissioner Craig Gaasvig**

218-766-9699

[cgaasvig@paulbunyan.net](mailto:cgaasvig@paulbunyan.net)

**District 2 Commissioner Reed Olson**

218-766-0383

[reed.olson@co.beltrami.mn.us](mailto:reed.olson@co.beltrami.mn.us)

**District 3 Commissioner Richard Anderson**

218-467-3275

[richard@paulbunyan.net](mailto:richard@paulbunyan.net)

**District 4 Commissioner Tim Sumner**

218-407-7589

[tsumner15@gmail.com](mailto:tsumner15@gmail.com)

**District 5 Commissioner Jim Lucachick**

218-586-3523

[lukmar@paulbunyan.net](mailto:lukmar@paulbunyan.net)

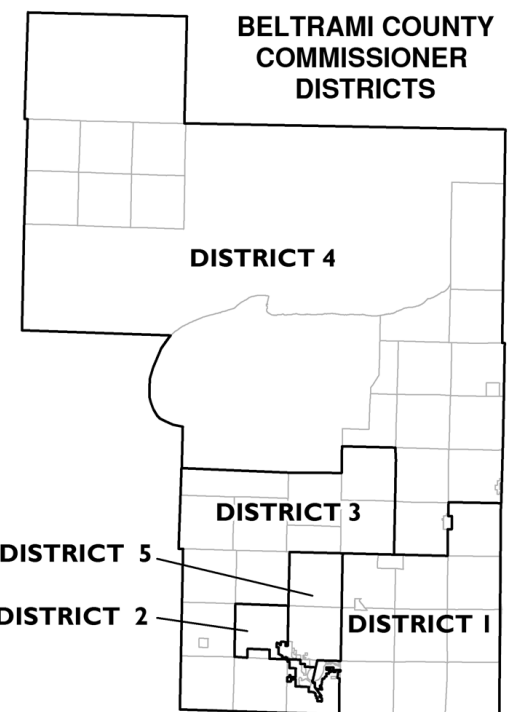

For additional information and detail, visit the County Board of Commissioners at [www.co.beltrami.mn.us/Government/Board\\_of\\_Commissioners.html](http://www.co.beltrami.mn.us/Government/Board_of_Commissioners.html)

## Northland Regional Shooting Sports Park

8257 HWY 89 N, Bemidji MN, 56619-1052

**Activities 2022**

Bemidji Area Shooters Association <https://www.bemidjishooters.org/>

3-Gun Competition, 4 events / The August Shooting Academy / Fire Arms Safety (FAS) 4 Field Days / Rimfire League (2) Competitions / Concealed Carry Permit classes / Handgun training- instructor, David Timm / Fall Rifle Sight In / Law Enforcement training day – night

The Nevada Firearms Leadership Training - April  
The Shooting Academy, August 20 and 21<sup>st</sup>

**Events**

American Trap Association's registered trap shoot - June 24,25 and 26.

The High School Clay Target League practice – 110-165 students from Bemidji, Bagley, and the Home School Team. Guest teams are shooting on Open Gun Club Nights while BHS has its own night due to high participation numbers.

Bemidji Trap and Skeet Club  
<https://www.trap-skeet.com/>  
Level I Coaches Training, March 19 & 20.  
Instructor Mike Townson - RSO & Concealed Carry class, the date TBA.  
(BHS Trap Team needs RSOs emphases will be on the sport of trap)

HSSF (Headwaters Shooting Sports Foundation) the over site board for the NRSP Northland Regional Sports Park, from this site one may reach links to the other organizations at the park <https://headwatersssf.org..>

## The No Till Drill

As we head into spring, local agriculture producers might want to consider modifying their seeding operations by utilizing Beltrami SWCD's no-till drill. By seeding with a no-till drill, you can consolidate your operation efforts, resulting in less fuel cost and time. On the bigger picture, less soil disturbance from a no-till operation can drastically improve your soil health. The drill is housed at Blackduck Co-Op AG Services and is available for producers to rent for a small per-acre fee.

To inquire further, contact the Beltrami SWCD at 218-333-4158.

~Submitted by: Conservation Technician, Aly Bergstrom

# Land Corner Remonumentation in Beltrami County

The United States Public Land Survey System (PLSS) was implemented shortly after the American Revolutionary War when the Federal Government became responsible for large areas of land west of the original thirteen states. The government wished both to distribute land to Revolutionary War soldiers in reward for their services as well as to sell land as a way of paying off Revolutionary War debt and funding government operations. Before this could happen, the land needed to be surveyed and thus a system of dividing land into Townships and Sections was created.

After the original surveys were conducted, the maintenance of the system was left to local land owners and governmental units. Evidence of the PLSS corner monuments that was originally set in the late 1890s and early 1900s is deteriorating and in some cases can no longer be located. The county's efforts in setting new durable permanent monuments, establishing new reference ties at these corner locations, and ensuring there is detailed documentation have been proven to reduce the cost of land survey work for Beltrami County's businesses, and residential or seasonal land owners. We've heard examples of how survey work ended up costing less than half of what was initially quoted before remonumentation work was done. It is also essential to recapture and preserve these corner locations for future generations because it is the foundation upon which all property boundaries are derived.

Since 2008, Beltrami County has invested nearly \$2 million in corner remonumentation at an average cost of about \$60,500 per township. The project has been funded primarily with money that comes from document recording fees. County Recorders in Minnesota have what is generally referred to as an unallocated fund, the primary purpose of which is to serve as a safety net to ensure that the County Recorder is able to record documents within statutory timeframes. The Beltrami County Recorder's Office has maintained recording compliance without the use of that safety net since 2007. When not needed for recording compliance, the fund is available for certain other expenses and our County Recorder has offered that fund for corner remonumentation needs. For the past couple years, the Natural Resource Management Department and the Highway Department have also contributed funds for corner remonumentation. Other Minnesota counties are looking at Beltrami County as one of the leaders in understanding how important this remonumentation project is for our land owners.

The map included here provides an overview of remonumentation progress within the county. Alaska, Langor, and Roosevelt Townships are currently being remonumented and will be finished later this year. The following townships are planned over the next few years:

- Battle, Cormant, and Quiring (beginning fall 2022)
- Birch and Taylor (beginning fall 2023)
- Moose Lake and Sugar Bush (beginning fall 2024)

County staff also recognize that there will be a need to establish and execute a long-term corner maintenance plan so that we don't repeat the situation where corner monuments are left unmaintained for a century until they eventually deteriorate, become disturbed or destroyed, or lost. There is also a legislative effort underway at the State level this year to provide dedicated grant funds for counties to maintain PLSS corner monuments. For more information, visit <https://mnpplss-umn.hub.arcgis.com>.

~Submitted by: GIS Director, Kevin Trappe

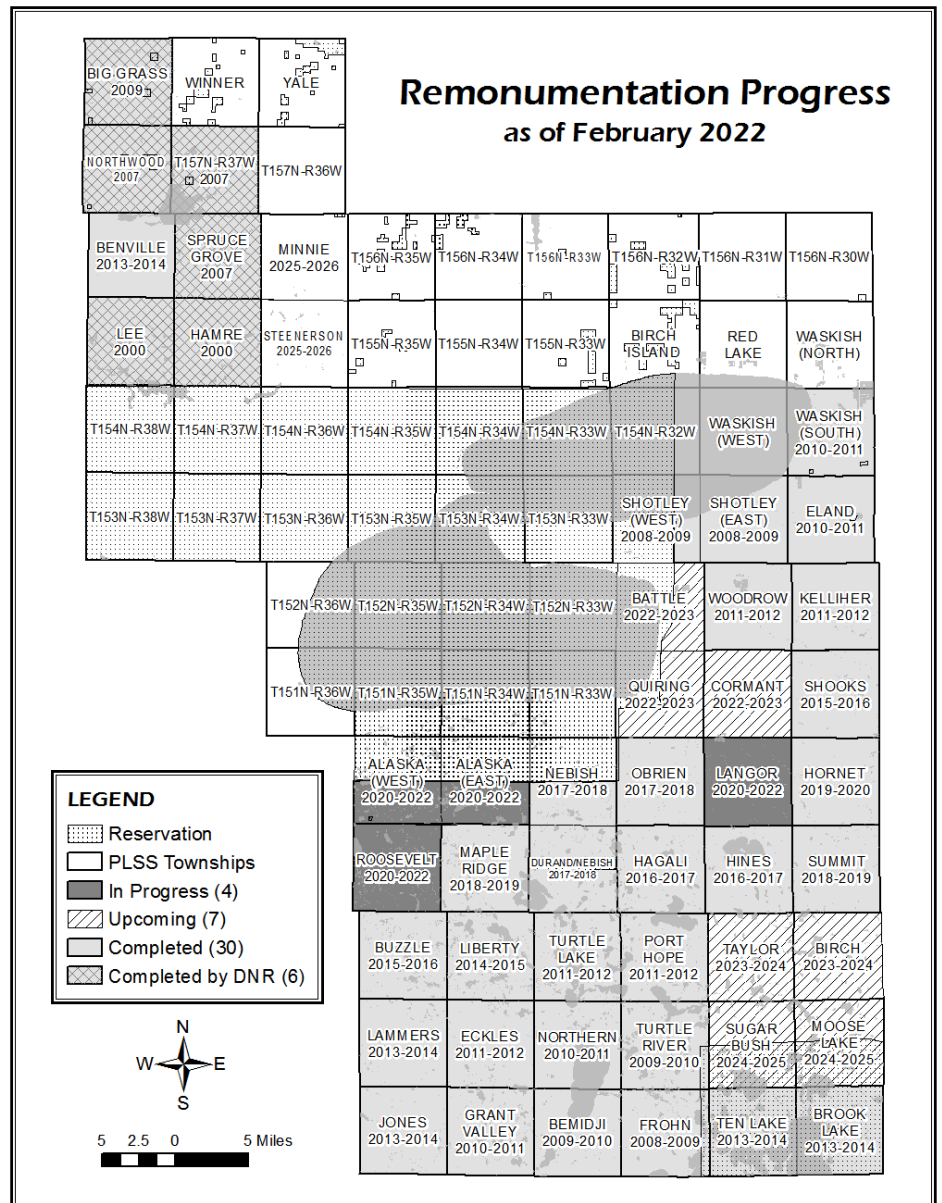

The Solway Elementary School had been using a tax-forfeited parcel south of Highway 2 as a School Forest since the 1950's. For various reasons over the years, the tax-forfeited parcel was never officially conveyed to the School District as a School Forest.

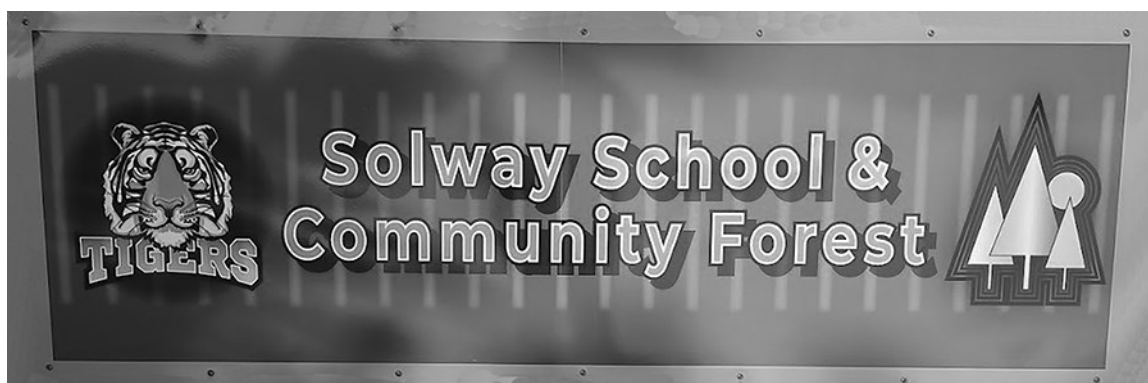

their previous location to the new School Forest location. A land survey of the site was completed and on August 3, 2021, the Beltrami County Board approved conveying these 17-acres to ISD #31 for school forest purposes.

Over the past two years, discussions between the County and Independent School District #31 identified and agreed upon a 17-acre tax-forfeited site immediately southwest of the Grant Creek Horse Camp in Section 30-T147N-R34W (Eckles Township). This site has access to amenities important to school children such as vault toilets, potable water, and picnic tables at the Horse Camp which makes it attractive as a School Forest location.

Since the conveyance and completion of the new trail system in the fall of 2021, the Solway Elementary School has been able to use the Scholl Forest and the trail system as part of their Fall Festival and Winter Carnival. During the Fall Festival, they had hay rides, games, and a bouncy house set up, and during their Winter Carnival, they had sleigh rides, sledding, hot cocoa, and a warm fire. The School also unveiled their new School Forest sign at their Winter Carnival in February of 2022.

~Submitted by: Recreation Resource Manager, Lori Clark

# Keep it Clean Campaign—Upper/Lower Red Lake

February 22, 2022: Upper Red Lake resorts and winter businesses, Beltrami Soil and Water Conservation District (SWCD), Upper Red Lake Area Association, and the Red Lake Watershed District have partnered to introduce the Keep It Clean campaign to Upper/Lower Red Lake.

Upper/Lower Red Lake is a foundational feature of the Red Lake Nation and is culturally and biologically vital to their daily lives. Protecting Miskwagamiwizaagaaiganing, the Anishinaabe word for Red Lake also protects cultural practices as part of reestablishing connections with ancestral traditions. Upper/Lower Red Lake is the largest natural freshwater lake located within Minnesota and the 6th largest natural freshwater lake located entirely within the lower 48 states; only the Great Lakes are larger by area. However, even with its size, the shallow nature of Upper Red Lake makes it highly sensitive to outside sources of pollution, and it is doubtful whether it can handle additional stress.

For years Upper Red Lake residents, guides, resorts, and the Kelliher High School have held various individual and group clean-up efforts, removing as much trash as possible from the ice, shorelines, and road ditches. However, Upper Red Lake has seen a dramatic increase in winter activity over the past decade. Figure 1 shows sustained growth in winter angling. In 2021, Upper Red Lake saw a record number of anglers, totaling an estimated 84,173 anglers with over 2.4 million hours of fishing! The increase in popularity of ice fishing has grown quickly with technology, better equipment, and wheelhouses, which make staying on the ice for extended periods of time more comfortable. With the increased activity comes more pressure on the natural resources, including an increase in the amount of garbage and waste left on the Lake.

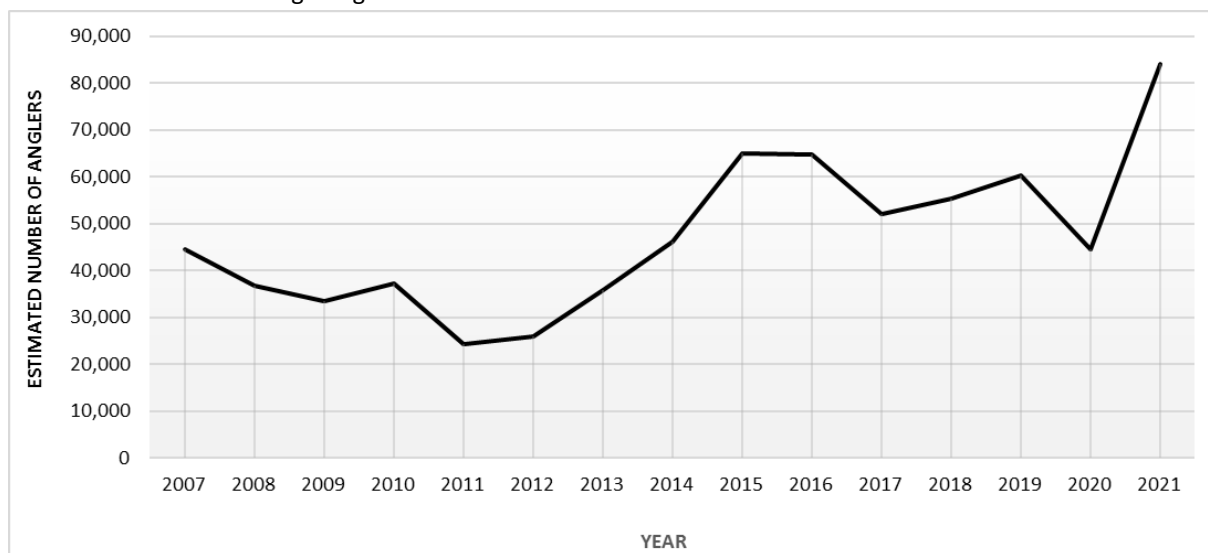

Figure 1- Estimated total number of anglers per year fishing Upper Red Lake.

This past year Beltrami SWCD was approached by the Upper Red Lake Area Association, who stressed the need for a coordinated effort to deal with increasing pressure on Upper Red Lake amid numerous anecdotal accounts of anglers leaving garbage, human bio-waste, and even emptying wheelhouse black water on the Lake. The SWCD, in working with the Association, resorts, and winter businesses, joined the Keep It Clean campaign. This program originated in Lake of the Woods in 2012, with the most recent chapter designed to address the growing problem of garbage and human waste left on Upper/Lower Red Lake.

Keep It Clean – Upper/Lower Red Lake is a local program that strives to increase awareness and coordinate efforts to make dealing with trash and human waste as easy as possible. We launched a media campaign this past January with a grant from the Upper Red Lake Area Association and have initiated a pilot disposal program with a grant from the Red Lake Watershed District totaling \$57,800 for the 2022-2023 winter seasons. Actions you can take right now that help reduce the amount of waste left on the ice, Keep It Clean encourages ice anglers and their guests to take the following steps:

- **Make a plan for trash and waste removal before you arrive.** Whether you access the Lake from public or private access, plan to take off the Lake what you take onto the Lake.
- **Never let your garbage touch the ice.** Wind is a major issue on large lakes and could inadvertently blow your garbage away. Always place in a separate container or in the back of a truck.
- **Use colored garbage bags.** In snowy conditions, white trash bags can be difficult to see. Brightly colored or even black bags are easier to spot, making it less likely that trash will inadvertently be left behind.
- **Take a moment before you depart** the ice to make sure that you have picked up any garbage in your area. If you notice someone else has left something behind, take a moment to pick it up and bring it with you.
- **Secure your garbage before traveling.** High winds, bumpy ice roads, and other conditions on or off the Lake can cause unsecured bags of garbage to fall out of truck beds and off trailers and sleds without you even realizing it.
- **Make sure you have the tools you need** to move or remove a fish house. Support blocks, insulation, landscaping fabric, wood, and other materials need to be properly disposed of, not left behind.

For more information: zachrie.gutknecht@co.beltrami.mn.us or visit <https://www.upperredlakeassn.com>



[www.co.beltrami.mn.us](http://www.co.beltrami.mn.us)

## Board of Commissioners

District 1—Craig Gaasvig .....	218-766-9699
District 2—Reed Olson .....	218-766-0383
District 3—Richard Anderson .....	218-467-3275
District 4—Tim Sumner .....	218-407-7589
District 5—Jim Lucachick .....	218-586-3523

## Administration Building

701 Minnesota Ave NW, Bemidji MN 56601

Administrator—Thomas Barry .....	218-333-4109
Assessor—Joe Skerik .....	218-333-4116
Auditor/Treasurer—JoDee Treat.....	218-333-4175
Environmental Services—Brent Rud .....	218-333-4158
Facilities Manager—Steve Shadrack .....	218-333-8475
Geographic Info Systems (GIS).Kevin T.	218-333-8457
Human Resources—Linda Tran .....	218-333-4155
License Center .....	218-333-4148
Mgmt Info Systems (MIS)—Kevin Warne	218-333-4151
Natural Resource Mgmt—Dick Moore ..	218-333-4210
Real Estate & Tax Services.....	218-333-4138
Recorder—Charlene Sturk.....	218-333-4170

## Community Service Center

616 America Ave NW, Bemidji MN 56601

Health & Human Services—Director Becky Secore	
Social Services - Director Jeff Lind .....	218-333-4223
Economic Assistance	
Director Anne Lindseth.....	218-333-8300
Public Health - Director Megan Heuer	218-333-8140
Veterans Services Shane Gustafson	218-333-4177

## Law Enforcement Center

613 Minnesota Ave NW, Bemidji MN 56601

Sheriff Ernie Beitel .....	218-333-9111
Bemidji Police Chief Mike Mastin.....	218-333-9111

## Judicial Center

600 Minnesota Ave NW, Bemidji MN 56601

Attorney—David Hanson.....	218-333-4219
Court Administration.....	218-333-4120

## County Jail

626 Minnesota Ave NW, Bemidji MN 56601

Main phone number.....	218-333-4189
------------------------	--------------

## Highway Department

2491 Adams Ave NW, Bemidji MN 56601

Highway Engineer—Bruce Hasbargen...	218-333-8173
-------------------------------------	--------------

## County Extension

7223 Fairgrounds Rd NW, Bemidji MN 56601

Extension Secretary .....	218-444-5722
---------------------------	--------------

## State Government Contacts

Office Of Governor, Tim Walz.....651-201-3400

### Senate

Justin Eichorn .....

Paul Utke .....

### House of Representatives

Matt Bliss .....

Matthew Grossell .....